

# CORVIN

## INNOVATION CAMPUS



***FUTUREAL***

# WELCOME TO THE CORVIN INNOVATION CAMPUS OFFICE BUILDING!

This guide contains all the most important information related to the **Corvin Innovation Campus** office building. We hope you enjoy it and use it on a regular basis.

*The Corvin Innovation Campus team*

1.	General information ..... 3
	<i>Address, Opening hours, Concierge service, Maintenance</i>
2.	Access ..... 6
	<i>On foot and by car</i>
3.	Parking..... 9
	<i>In the office building: underground car park Near the office</i>
4.	Services ..... 15
	<i>Office building, shops, services on Corvin Promenade and nearby</i>
5.	The sustainable office building ..... 21

# 1. GENERAL INFORMATION

# General information

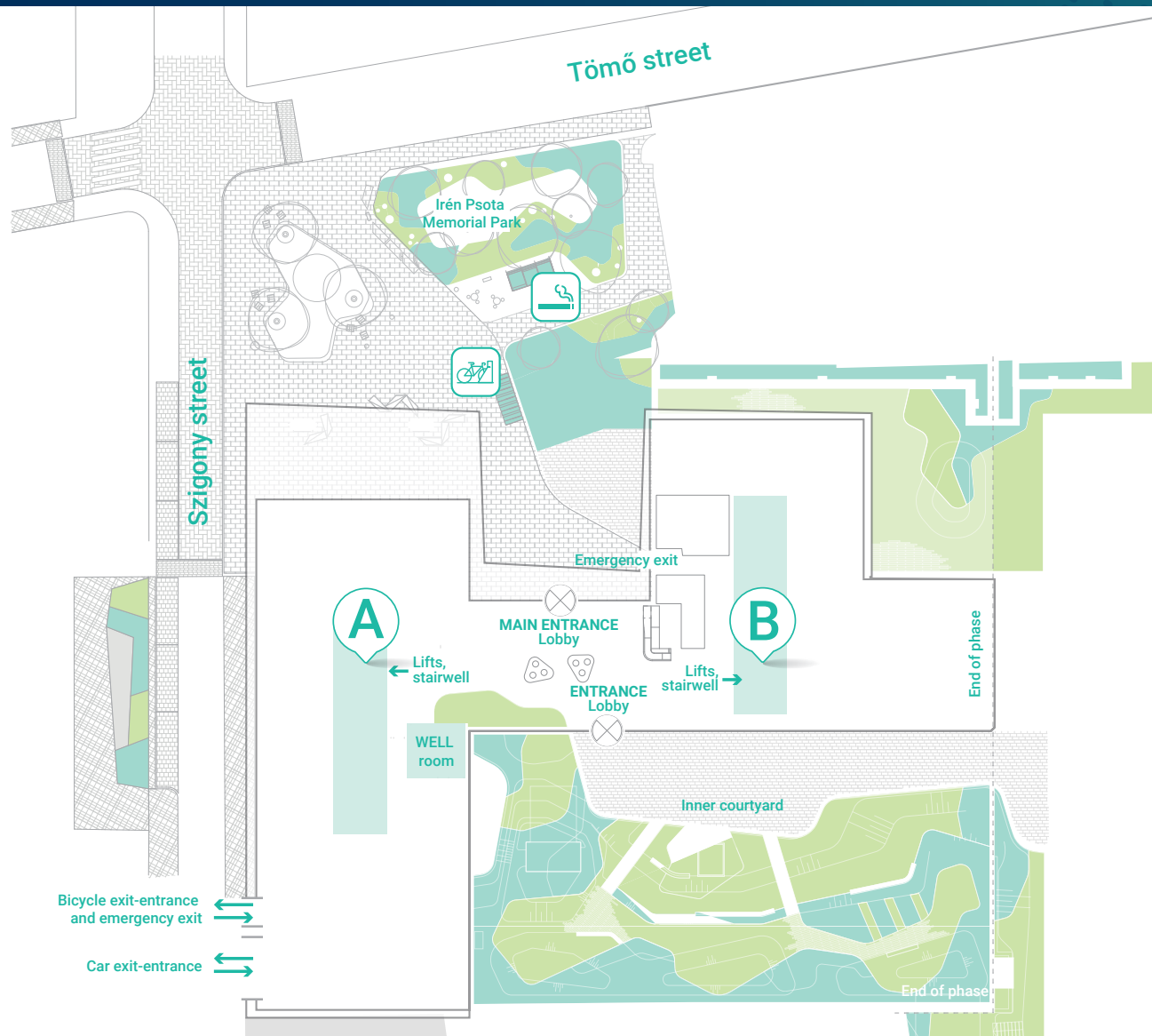

## **CORVIN** INNOVATION CAMPUS OFFICE BUILDING

**Phase 1**  
26–32 Szigony Street, Budapest 1083

**Opening hours:** 24 hours with security



# General information

## Concierge Service

- The Corvin Innovation Campus is open **24 hours** a day and has a reception desk
- Assistance with receiving visitors and providing orientation around the office building are provided at the **main reception**
- You can have packages, letters and food delivered to the delivery point in the lobby

## Maintenance, online problem reporting

**Building operated by:** Dome Facility Service Kft.

- 24-hour operational monitoring on site
- **24-hour problem reporting system:**  
Please contact the relevant staff member within your company, as only the designated person can use the report page
- To view a detailed building manual, please speak to one of your colleagues who is in contact with Dome Facility
- 24-hour security service:  
+36 70 389 8258

## Other relevant information



## 2. ACCESS

# Pedestrian and bicycle access

The office building is easily accessible on foot. The **4/6 tram** and the **M3 metro line** are just a few minutes' walk away, which means you can easily reach **Kálvin Square, Blaha Lujza Square, Népliget, and the Keleti and Nyugati train stations**, as well as the Buda side and numerous other parts of the city.

Arriving by bicycle, you can find safe bicycle lanes on the main boulevard and **Üllői Road**, the final section designed as part of the **Szigony Street - Tömő Street** urban development.

## Walking distance from the Corvin Innovation Campus office building

Üllői Road – Ferenc Boulevard  
intersection

 **M3 metro**

Corvin Quarter

 **M3 metro**

Klinikák

 **4-6 tram**

Corvin Quarter

1 km

1 km

300 m

1 km

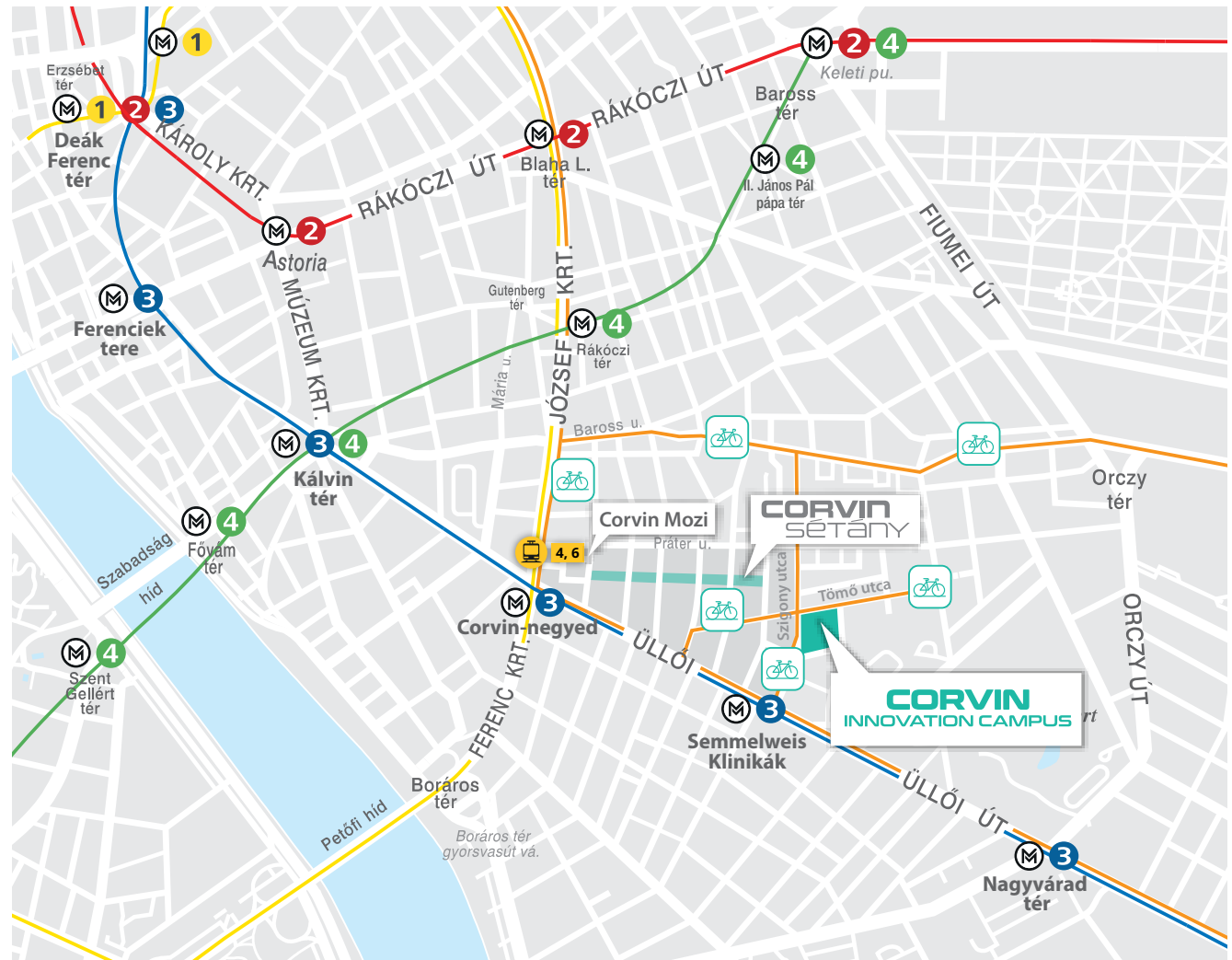

# Car access

By car, you can access the underground car park of the **Corvin Innovation Campus** office building from the **Ferenc Boulevard** side via **Tömő Street**, in the direction of **Nagyvárad Square**, via **Bókay János Street**, or by turning onto **Szigony Street**.

When leaving the car park, you can turn on to **Üllői Road** in both directions, while towards **Baross Street**, cars can travel on the **Apáthy István Street – Tömő Street – Szigony Street** route.

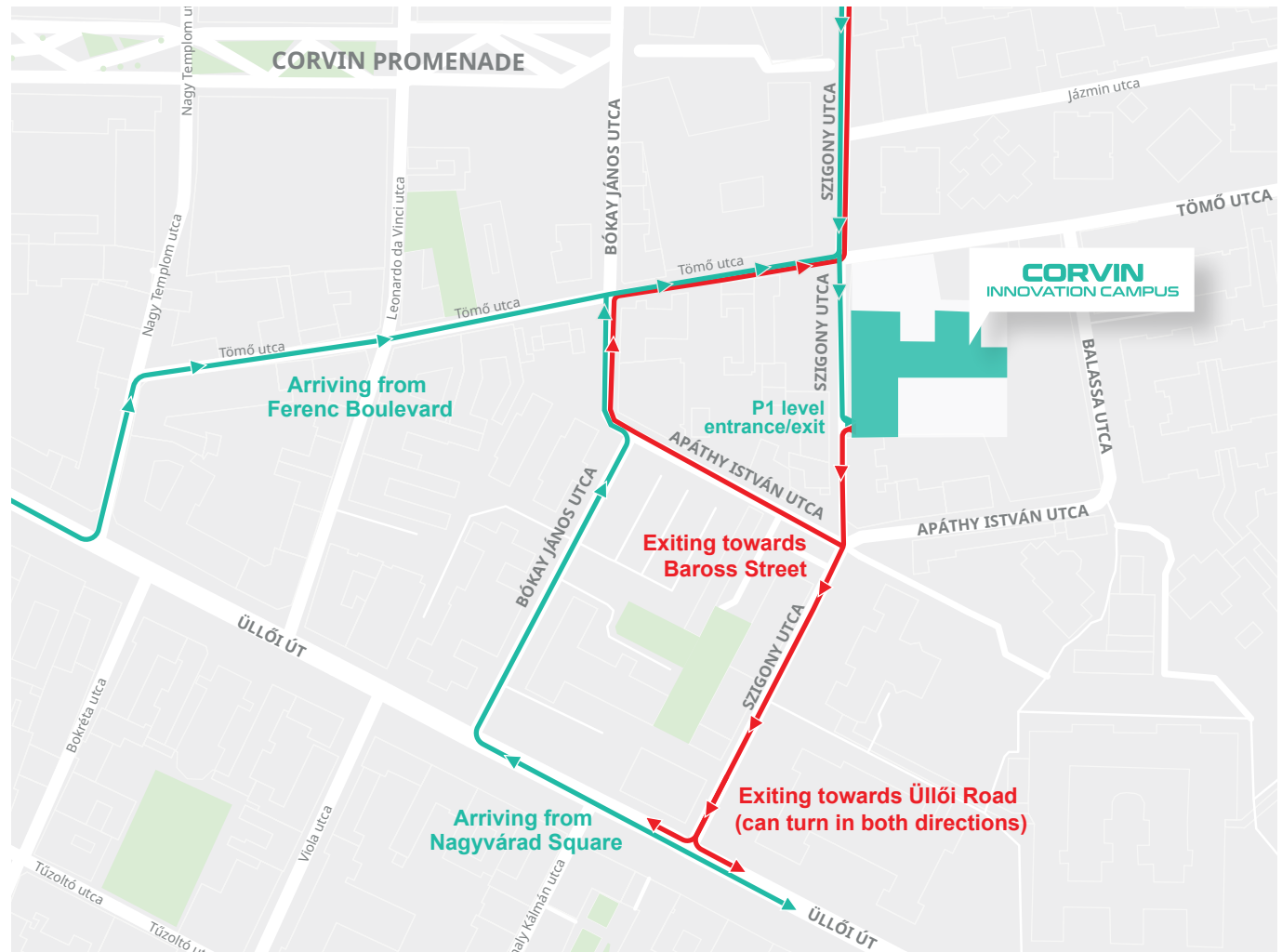



# 3. PARKING



# Office building underground car park

## P1 LEVEL

You can enter the office building underground car park from Szigony Street.  
There are electric car charging points and bicycle racks available in the three-level car park.

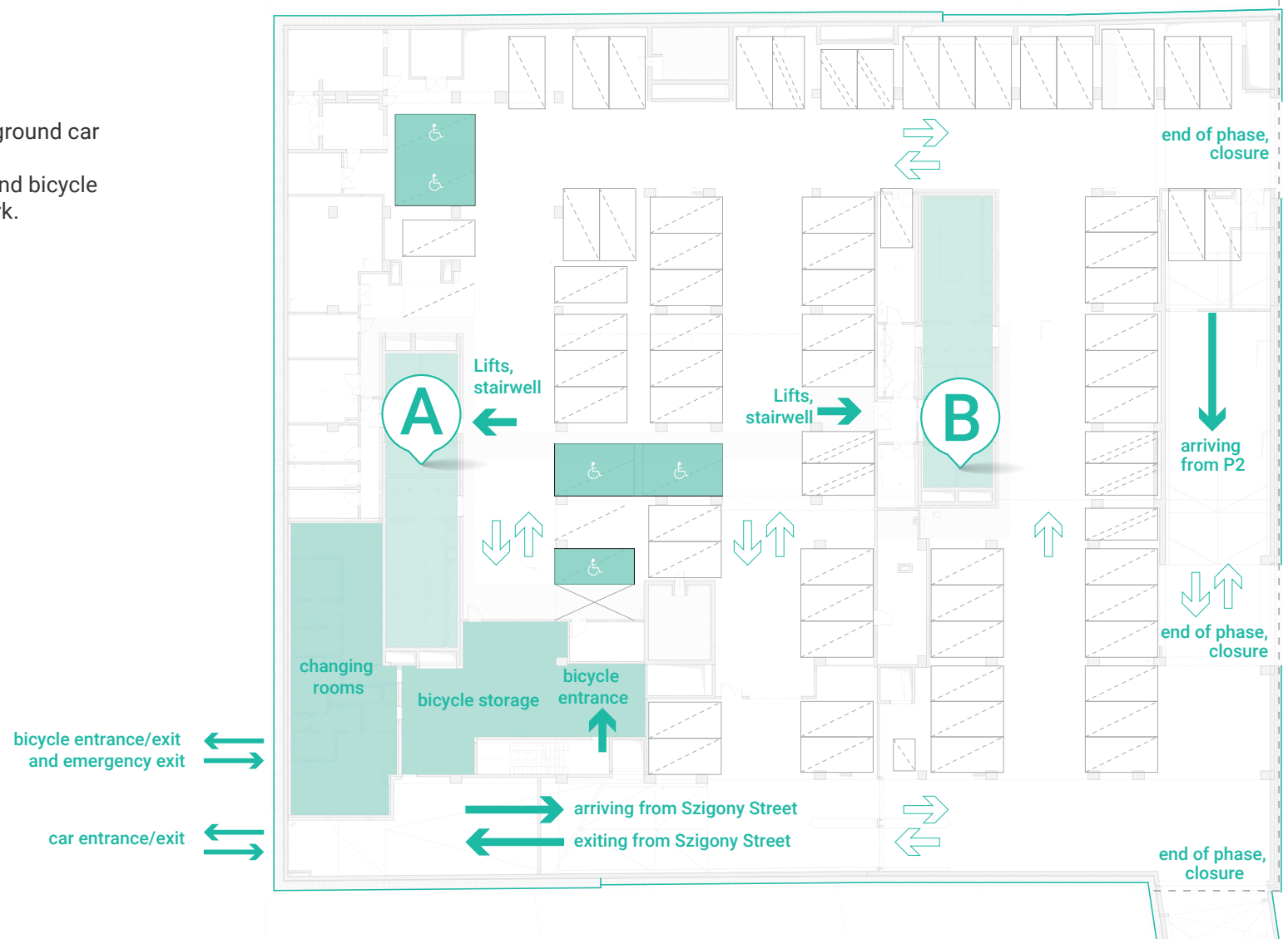

# Office building underground car park

## P2 LEVEL

You can enter the office building underground car park from Szigony Street.  
There are electric car charging points and bicycle racks available in the three-level car park.

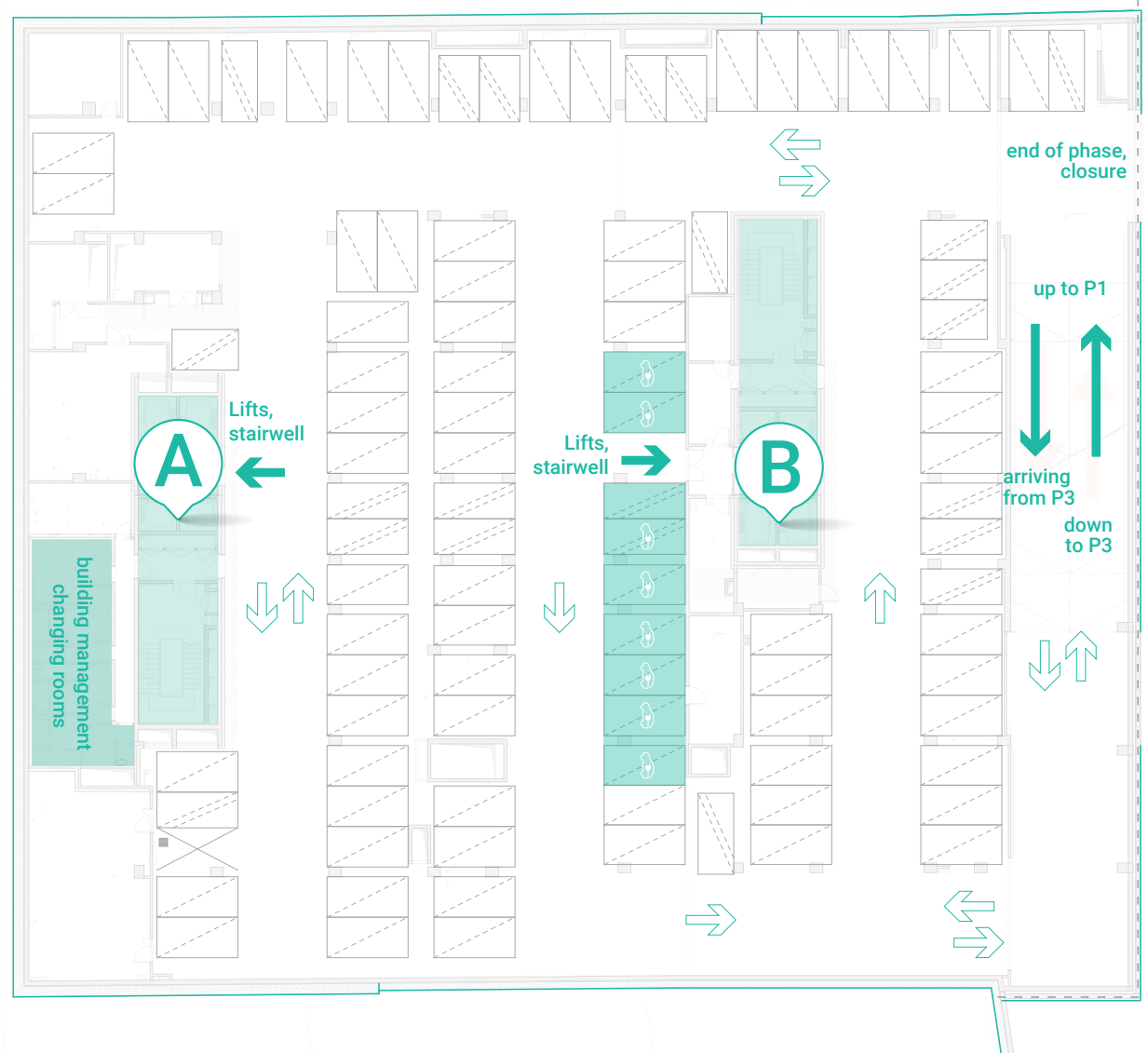

# Office building underground car park

## P3 LEVEL

You can enter the office building underground car park from Szigony Street.  
There are electric car charging points and bicycle racks available in the three-level car park.

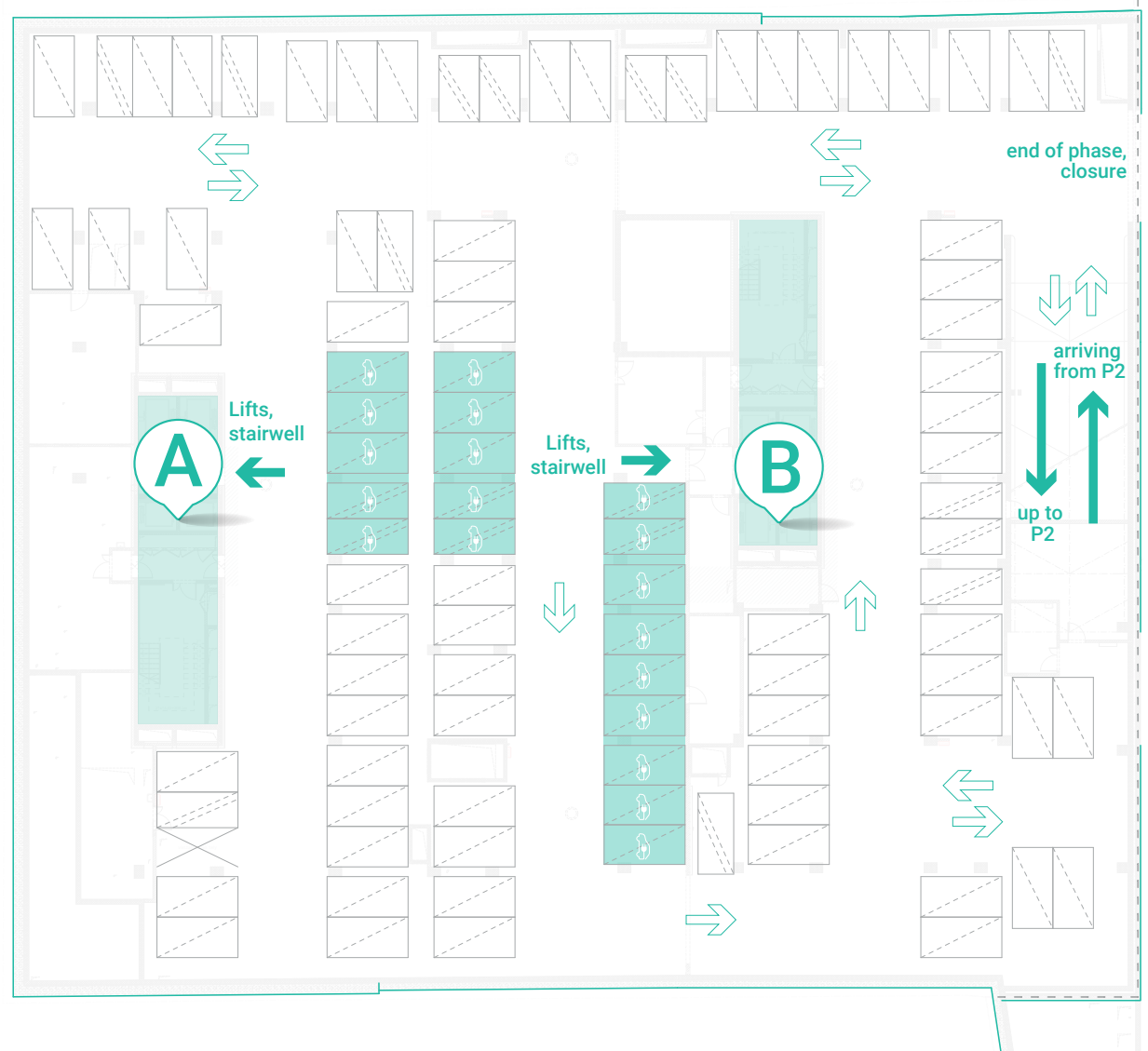

# Office building underground car park

## PARKING USAGE GUIDE



### 1. Download application

Parkl is available for both Android and iOS

### 2. Registration

Fast registration in the app with just a few details (email address, number plate, phone number, bankcard details)

### 3. Request authorisation

If you would like to park at the office building, please find your relevant admin colleague, who will provide you with the authorisation needed to utilise this service.

### 4. Parking in the office building

Automatic entrance/exit and barrier opening in the garage of the office building, without any mobile phone required, with the help of a number-plate recognition camera. If the barrier does not open automatically, please click on the occupied or rented space in the Parkl system, then press 'open barrier' to activate the barrier. Please only use your entry card to enter/exit the car park if the Parkl system is not working.

### 5. Electric car charging

After opening the app, select the number of the electric charge point, then press the 'start' button, before closing it in the same menu point.

### 6. Visitor parking

To arrange visitor parking, please contact the colleague responsible, who can create a new invitation for the visitor and forward it to them. The visitor can enter using the number plate recognition and does not need to download the app. If the visitor does have the app, they can use it to activate the barrier.

- The **instant parking** function is available for the Corvin Innovation Campus underground car park. This enables users to enter automatically and open the barrier, **with no need to take out your mobile phone**.
- In addition to instant parking, you can also use the app to open the barrier.

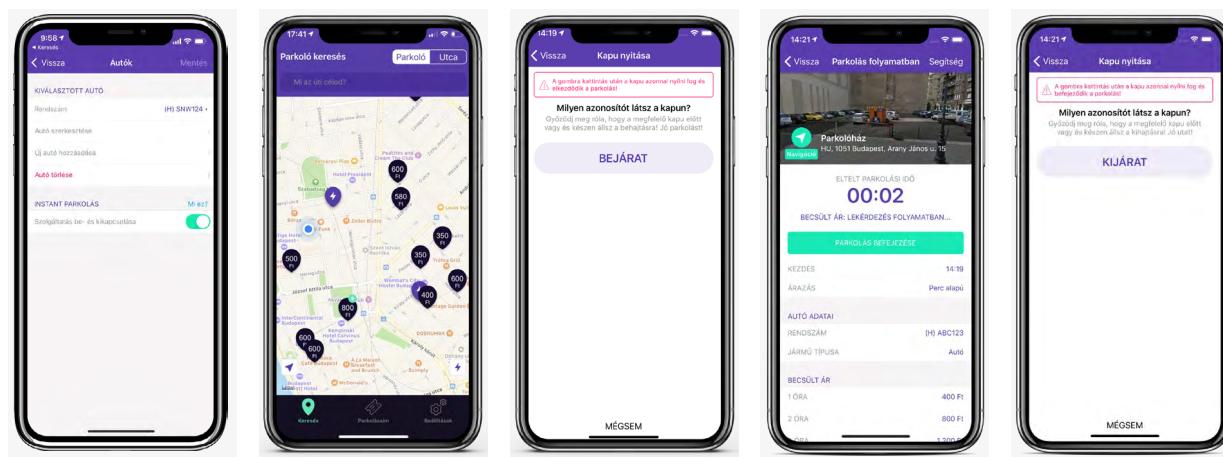

# Car parks nearby the office building

There are several P+R car parks operating close to the Corvin Innovation Campus.

For people arriving by car, in addition to the underground car park and the free spaces in the neighbouring streets, the following options are also available:

	DISTANCE		TIME	
	On foot	Car	On foot	Car
Public7 Parking House	2 km	2.6 km	25 min.	9 min.
Stop Parking	1.1 km	1.8 km	14 min.	5 min.
Corvin Plaza Car Park	750 m	1.8 km	9 min.	5 min.

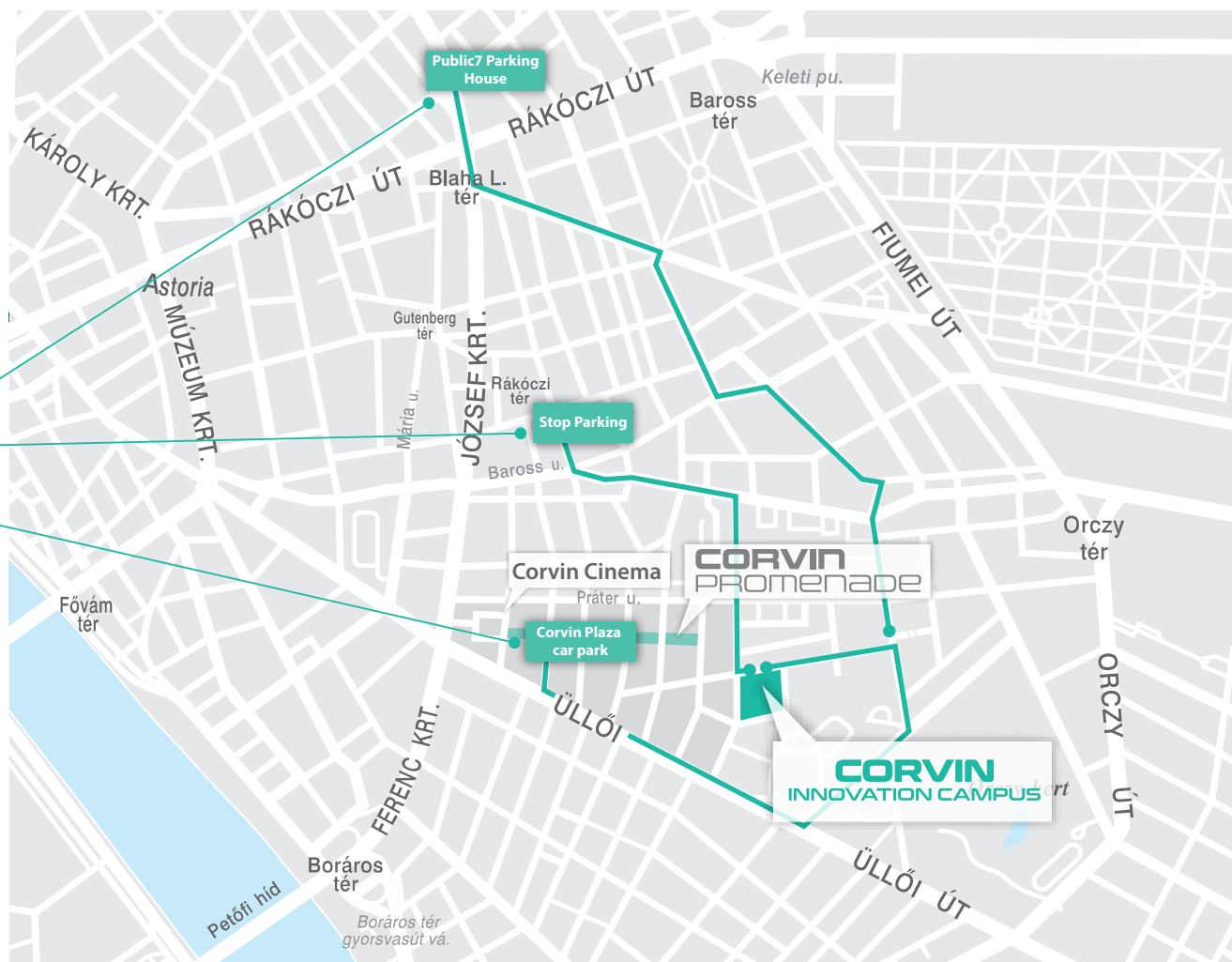



# 4. SERVICES

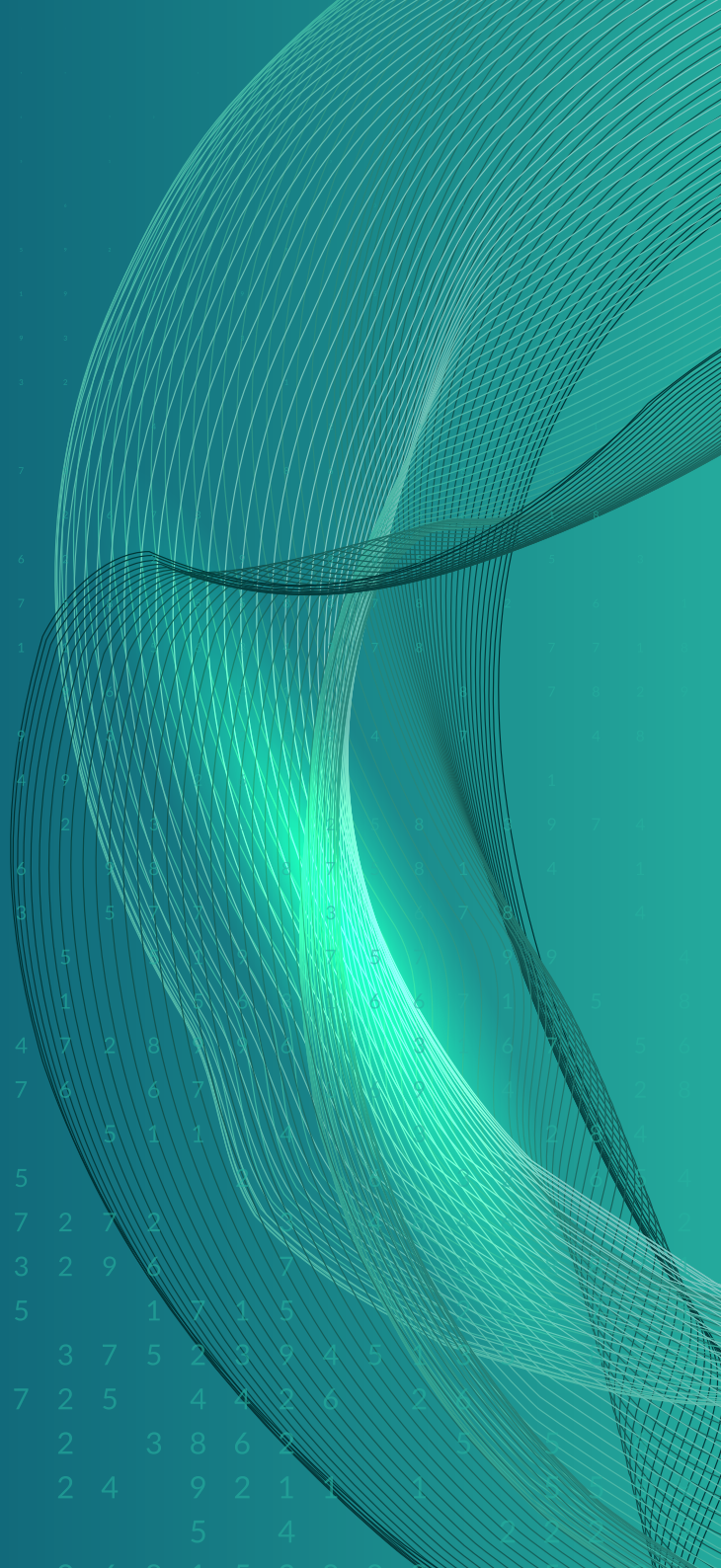

# Services and shops close to office building



# Services and shops close to office building

## RESTAURANTS, CAFES

- [Cserpes Tejivó](#)
- [Sushiroll](#)
- [Café Color Waffle Bar](#)
- [Grill Chicken](#)
- [Cook J. noodles](#)
- [Fészek Cake Shop](#)
- [Cinema sushi bar](#)
- [Mézédes Cake Shop](#)
- [Caffe Vergnano](#)
- [Pizza Forte](#)
- [10 minutes cafe bistro](#)
- [Epic Burger](#)
- [Amici Mie](#)
- [Hummusbar](#)
- [Sunday](#)
- [Kompót](#)
- [Sakura Ramen](#)
- [Spicy Fish Budapest](#)
- [California Coffee Company](#)

- [Madame Pho](#)
- [Padthai Wokbar](#)
- [Cafe Frei](#)
- [Gnocco restaurant](#)
- [Cortez](#)
- [Oriental Market](#)
- [Mr. Fruit Delicates](#)
- [Tripla Hofmann](#)
- [Vino Wonka Wine Bar](#)
- [Foodie](#)
- [YU Grill](#)
- [Grund](#)

## PETROL STATIONS

- [MOL petrol station](#)

## BANKS

- [Erste Bank](#)
- [K&H Bank](#)
- [OTP Bank](#)
- [Takarékbank](#)

## SHOPPING

- [Príma](#)
- [Cream second-hand clothes](#)
- [WOW Market](#)
- [Duovital](#)
- [Gamertech](#)
- [National Smoking Shop](#)
- [Mobee](#) (mobile phones and service)
- [Corvin Pet Shop](#)
- [Elite Body Shop](#)
- [Rossmann](#)
- [Bortársaság](#)
- [Lidl](#)
- [Kristály Décor](#)

## HOTEL

- [Corvin Center Suites - Atempo residence](#)
- [Hotel City Inn](#)
- [Corvin Lux aparthotel](#)

## ENTERTAINMENT

- [Corvin Cinema](#)
- [Duma Theatre](#)
- [Las Vegas Casino](#)

## SERVICES

- [LIFE1](#)
- [Bubbles](#)
- [Virág-Flowers](#)
- [Arizonia Lottery](#)
- [Corvin Barber](#)

## HEALTHCARE

- [Smile Terminal](#)
- [Evital pharmacy](#)

# Kindergartens, daycare close to the office building

## DAYCARE

- |                                     |                                  |
|-------------------------------------|----------------------------------|
| 1 Babóca Daycare                    | 🚶 10 min - Baross st. 117.       |
| 2 Ferencvárosi Aprók Háza Daycare   | 🚶 21 min - Ráday st. 46.         |
| 3 Ferencvárosi Varázskert Daycare   | 🚶 8 min - Thaly Kálmán u. 17.    |
| 4 Gólyafészek Daycare and Playhouse | 🚶 4 min - Bókay János u. 34.     |
| 5 Józsefvárosi Babóca Daycare       | 🚶 10 min - Baross st. 117.       |
| 6 Lepke-lak Family Daycare          | 🚶 10 min - Ferenc sq. 13.        |
| 7 MindenKid Corvin Daycare          | 🚶 2 min - Szigony st. 25.        |
| 8 Mini Manó Daycare                 | 🚶 9 min - Baross st. 103a        |
| 9 Nagytemplom Daycare               | 🚶 7 min - Nagy Templom st. 3.    |
| 10 Nokia Daycare                    | 🚶 2 min - Bókay János st. 36-42. |
| 11 Prücsök Otthon Family Daycare    | 🚶 16 min - Vaskapu st. 10-14.    |

## KINDERGARTEN

- |                                      |                                |
|--------------------------------------|--------------------------------|
| 1 Bástya Kindergarten                | 🚶 26 min - Bástya st. 4.       |
| 2 Corvinpintyőke Family Kindergarten | 🚶 6 min - Corvin sétány 1/b    |
| 3 Csicsergő Kindergarten             | 🚶 8 min - Thaly Kálmán st. 38. |
| 4 Csodasziget Member Kindergarten    | 🚶 1 min - Tömő st. 38/a        |
| 5 Gyerek-Virág Member Kindergarten   | 🚶 8 min - Baross st. 111/b     |
| 6 Kicsi Bocs Kindergarten            | 🚶 24 min - Erkel st. 10.       |
| 7 Koszorú Kindergarten               | 🚶 7 min - Koszorú st. 14-16.   |
| 8 Liliom Kindergarten                | 🚶 15 min - Liliom st. 15.      |
| 9 MindenKid Corvin Kindergarten      | 🚶 2 min - Szigony st. 25.      |
| 10 Tesz-Vesz Kindergarten            | 🚶 8 min - Baross st. 91.       |
| 11 Virágkoszorú Member Kindergarten  | 🚶 8 min - Baross st. 91.       |

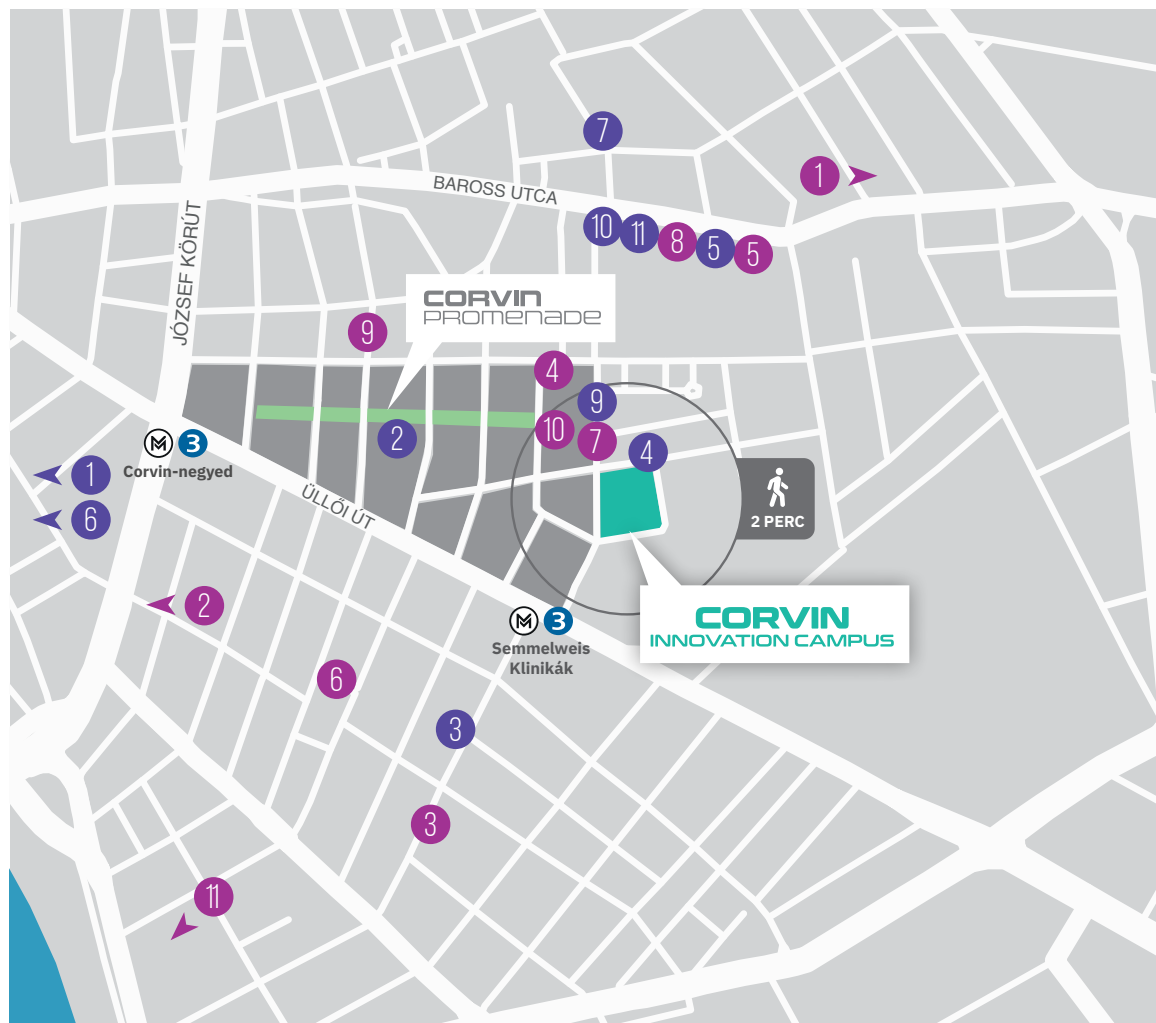



# Health facilities within five minutes' walk

- |                                      |         |
|--------------------------------------|---------|
| 1 Plazma Point Corvin                | 0.6 km  |
| 2 Szent Rókus Hospital               | 1.6 km  |
| 3 Corvin Medical Centre              | 0.45 km |
| 4 South-Pest Hospital Centre         | 1.4 km  |
| 5 Downtown Medical Centre Kft.       | 1 km    |
| 6 Szent István Hospital              | 1.12 km |
| 7 Semmelweis University Patient Care | 0.25 km |
| 8 Benyovsky Medical Centre           | 1 km    |
| 9 Ju-Med Health Centre               | 1 km    |
| 10 Medaid Clinic                     | 1.5 km  |
| 11 Alma Health Centre                | 0.6 km  |
| 12 Swiss Medical                     | 1 km    |
| 13 Accident Institute                | 1.35 km |





# Services

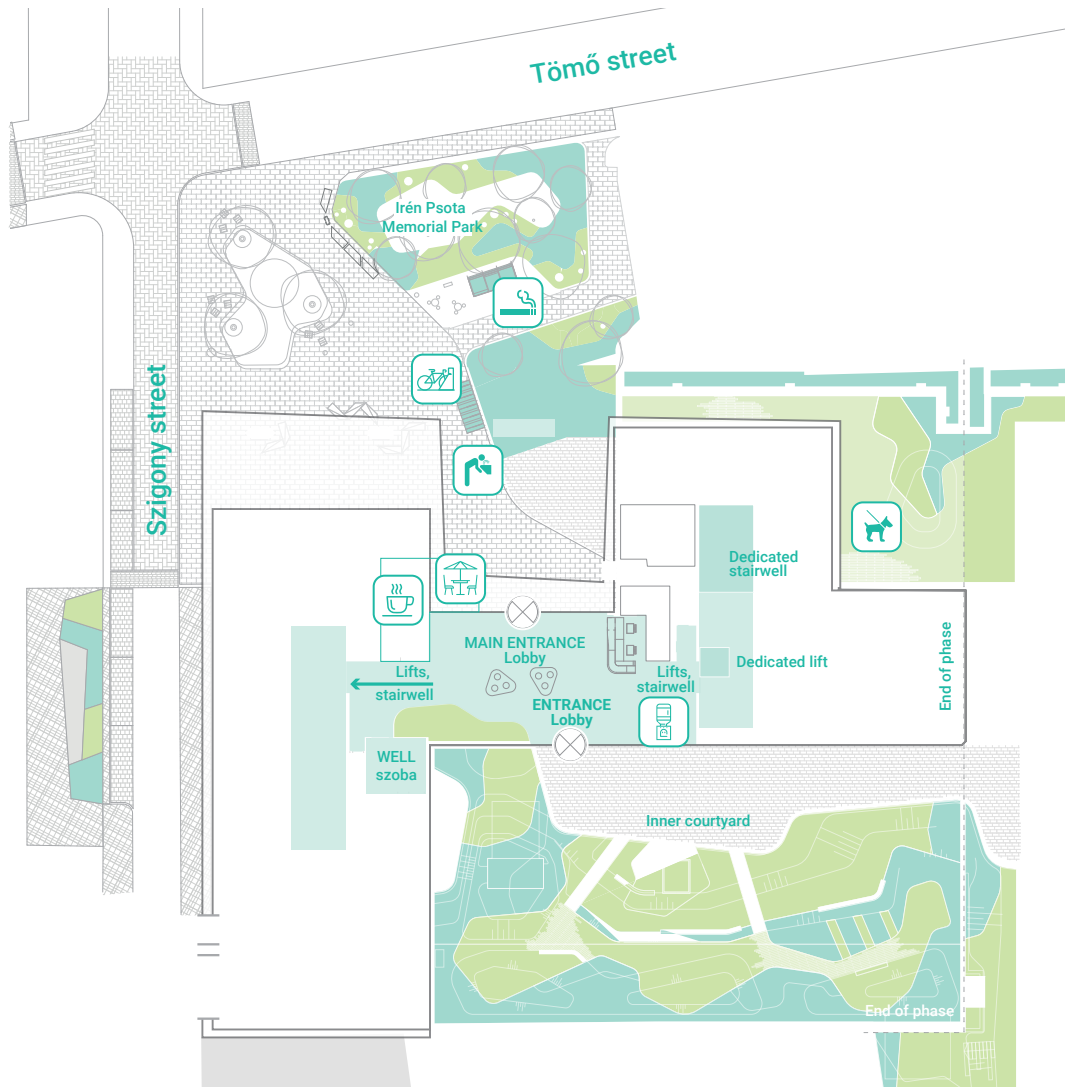

- **Receiving guests:** use the QR code entry system. Please contact your office manager for information on how to use this service
- **Defibrillator:** one unit available, in ground floor lobby of B tower. In the event of an emergency, please call the 24-hour security service at +36 70 389 8258 and also notify the ambulance service (104).
- **Wifi:** 4G coverage is provided in the entire building on the garage floors, stairwells, elevators and common areas on the ground floor.
- **WELL room:** Located on the office ground floor in the retail area. Whether you're interested in relaxation, exercise, learning or group development, cultural and charity programmes, clubs, organising fairs, executive health screenings, professional discussions, games or even pop-up services (e.g. sewing, manicures-pedicures), this is the perfect space to help you reach your goal, be it team building, relaxation, self-organisation, learning, play or good health!



**WELL room programmes and participation conditions.**

<https://system.easypartice.net/book/well-room#choose-service>



**More information about WELL room here.**

[https://www.futurealgroup.com/wp-content/uploads/2023/03/well\\_kisokos.pdf](https://www.futurealgroup.com/wp-content/uploads/2023/03/well_kisokos.pdf)

- **Electric car charging points:** Electric car charging points are available for tenants in the office building's underground car park.
- **Smoking:** There is a designated smoking place in pavilion on the corner site. Smoking is not permitted in other areas (internal courtyard, terraces, etc.).
- **Other:**
  - **Available on the ground floor:** delivery point, shoe polish machine, reading corner with WELL library, battery collection point, water cooler.
  - **Available on car park floors:** changing room for cyclists, shower for cyclists, bicycle maintenance station.

# Dog-friendly office building

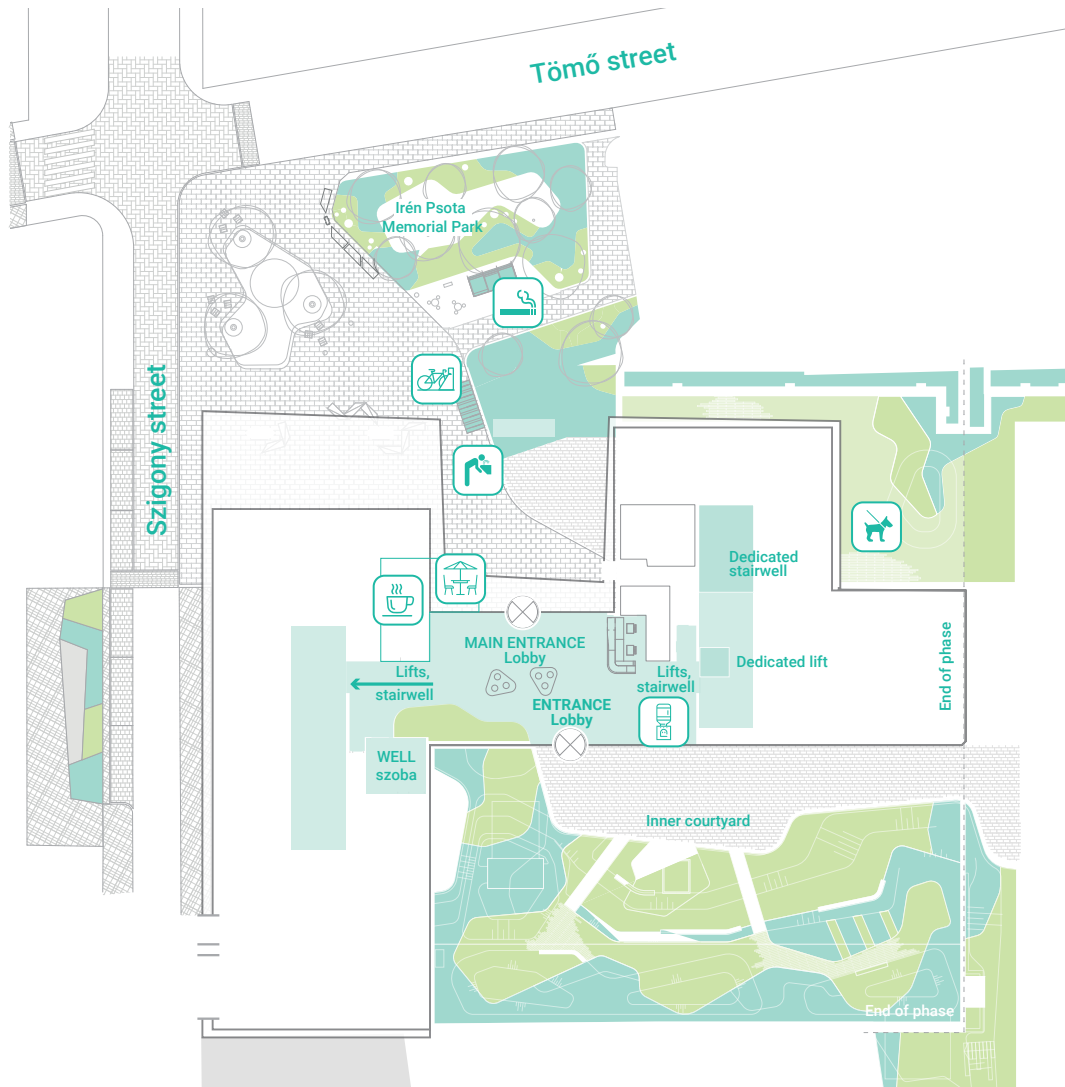

The Corvin Innovation Campus is a dog-friendly office building, contributing to the wellbeing of the people who work here. Pets help reduce workplace stress, can increase productivity and also contribute to the creation of a healthy, friendly office environment.

Since every fourth adult in Budapest is a dog owner and pets are often central to the lives of younger workers, a dog-friendly office can make for a particularly attractive workplace.

On the site of the office building, there is a special dog park and clean drinking water is always available.

For further details about the rules regarding the dog-friendly office building:  
[CIC pet-friendly code of conduct](#)

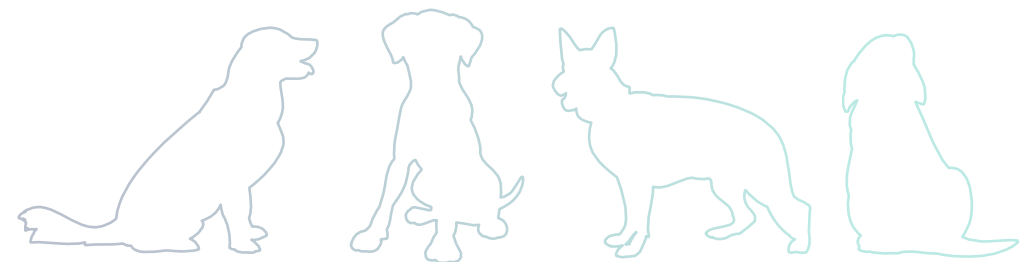

# 5. THE SUSTAINABLE OFFICE BUILDING



# What makes Corvin Innovation Campus a sustainable office building?



## HEALTH AND WELLBEING

- monitored air quality
- reduction of number of contacts in common areas
- highly adjustable, glare-free lighting
- careful design of acoustic and thermal comfort
- accessible environment that complies with the principles of universal design
- biophilic design
- soothing wall colours
- multifunctional room
- nearby fitness facilities
- bike storage and showers



## CLEAN WATER AND BASIC SANITATION

- monitored water quality
- accessible water points in the lobbies and at the jogging track
- protection against legionella bacteria



## AFFORDABLE AND CLEAN ENERGY

- AA+ highly energy-efficient energy classified building
- 0% local CO2 emissions through district heating
- the electricity needs of the office building are partly provided for by a solar panel system
- heat recovery ventilation system
- advanced building automation system

# What makes Corvin Innovation Campus a sustainable office building?



## A GOOD DAY'S WORK AND ECONOMIC GROWTH

- we provide a suitable, well-equipped, healthy and safe working environment for our tenants' employees



## SUSTAINABLE CITIES AND COMMUNITIES

- an office building in the immediate vicinity of a multimodal transportation hub
- an inner courtyard offering a range of recreational opportunities for everyone, including the local community



## ACTION TO COMBAT CLIMATE CHANGE

- building structures resistant to weather conditions and climate change
- measurement of water and energy consumption integrated into the BMS system
- presence sensors and leakage detectors
- low-energy elevators
- a weather-controlled, low-consumption irrigation system
- low water consumption sanitary fittings
- use of sunshades and awnings
- selective waste collection (including glass) and compaction
- a high level of recycling (at least 75% for non-hazardous waste) of construction and demolition waste from the construction of the building



# What makes Corvin Innovation Campus a sustainable office building?



15

LIFE  
ON LAND



## PROTECTING TERRESTRIAL ECOSYSTEMS

- a garden enhancing biodiversity
- meeting BREEAM ecological requirements



17

PARTNERSHIPS  
FOR THE GOALS



## PARTNERSHIP TO ACHIEVE OBJECTIVES

- Futureal is planting forests on external sites
- Futureal is a founding member of the Hungary Green Building Council (HuGBC), a professional platform and community that has been active in all areas of the building industry since 2009. We provide professional advocacy on current and future issues to achieve a sustainable built environment. As a member of the international community of the World Green Building Council, we provide a knowledge base and platform to raise awareness and for educational activities that builds on forward-looking international practices and the knowledge, as well as the experience and innovative solutions of our members.



- **Phase I.:** WELL CORE rating awarded
- **Phase 1 and 2:** Excellent rating awarded for the design phase in the BREEAM New Construction International system

# What makes Corvin Innovation Campus a sustainable office building?



The British Building Research Establishment (BRE), which developed and operates the BREEAM system, has made the rating system available on international markets since 2008. The system groups sustainability criteria into nine categories, providing a holistic way to measure the performance of a certified project. The criteria typically follow European or national standards. New-build projects are typically rated in two stages, the design stage and the post-construction stage.



The WELL certification from the United States is one of the most up-to-date international certification systems available in Hungary. This scheme differs from, for example, the BREEAM certification in that it focuses specifically on the design and assessment of healthy and more liveable indoor spaces. For this reason, the developers of the WELL Standard explicitly recommend that, in addition to the WELL certification, the entire project to be certified should also be rated according to one of the green building certification systems. The new version of the WELL rating system sets out basic requirements and recommendations for creating a better indoor environment in ten areas: air quality, water, nutrition, light, movement, thermal comfort, acoustics, use of materials, the mental environment and community. It is also possible to obtain pre-certification in the design stage, which allows the project to be identified as a health-promoting building at an early stage. At the end of the project, after verification of the documentation submitted, the project receives the final rating following on-site inspections, measurements and sampling.

# What can you do to help promote sustainability!



**BE KIND TO THE ENVIRONMENT:  
RIDE YOUR BIKE TO WORK!**



## Did you know...

- ... an average car emits 20-80 tonnes of CO<sub>2</sub> into the air during its entire life cycle, and not only when you step on the accelerator!
- ... vehicle emissions are a major contributor to the increase in the concentration of climate change-causing gases in the atmosphere!
- ... pollutants contain large amounts of substances that cause cancer or harm the respiratory system; children between the ages of 0 and 4 are most at risk!
- ... 300,000 people die every year in the EU as a result of ultrafine particle emissions from cars!

## How you can help...

- Do not get into the car for short trips, because fuel consumption and CO<sub>2</sub> emissions are much higher when the engine is cold!
- Walk or use public transport instead of driving!
- Try creative eco-innovations: AeYo, OneWheel, SoloWheel or Segway, electric skateboards, electric scooters and roller skates!
- Take part in the "Bike to Work" campaign with Bubi bicycles or your own bike\*!

# What can you do to help promote sustainability!



## WATER IS THE SOURCE OF LIFE



### Did you know...

... water is one of the most important elements of the biosphere!

... it covers 70% of the Earth's surface, but only 2.5% of it is fresh water!

... more than 1.1 billion people on Earth do not have access to fresh drinking water, and 2 billion live in inadequate sanitary conditions, which causes 5 million deaths every year!

... in Hungary, the average water consumption is 100 liters per person per day!

### How you can help...

Do not run the tap unnecessarily!

Start the washing machine and dishwasher when it is full!

Take a quick shower instead of a bath!

When using the toilet, small buttons are for small things, big buttons are for big things...



# What can you do to help promote sustainability!



**EVERY SHEET OF PAPER  
WAS BORN A TREE**



## Did you know...

... more water is needed to produce a ton of paper than to make any other product!

... the paper industry is the third largest sector in terms of fossil energy use, and the chlorine used to bleach paper is also extremely harmful to the environment!

... an old tree produces 200 kg of oxygen – more than one person needs for a year!

## How you can help...

Do not print or photocopy or, if it's unavoidable,

Print double-sided!

Make notes on used paper!

You can save the lives of trees with recycled paper!

# What can you do to help promote sustainability!



**NOTHING IS MORE  
NATURAL THAN NATURAL  
LIGHT!**



## Did you know...

- ... old-style light bulbs waste 95% of energy!
- ... poor lighting can also impair the efficiency of your work and cause headaches, eye pain, drowsiness, dizziness, back and neck pain, and general fatigue!
- ... if you use a desk lamp instead of ceiling lighting, you don't consume electricity unnecessarily and you can see even better!

## How you can help...

- When you leave the room, turn off the light after you!
- Use compact fluorescent lighting or switch to LED!
- Don't 'overlight' your surroundings, strive for optimal lighting

# What can you do to help promote sustainability!



**HEALTHY BODY,  
HEALTHY SPIRIT!**



## Did you know...

- ... indoor air quality has a significant impact on your health!
- ... houseplants filter out carbon dioxide and improve indoor air quality!
- ... the evaporation of materials and furniture found indoors can also be harmful to your health!

## How you can help...

Keep your environment clean, you can avoid many infections by washing your hands frequently!

Surround yourself with plants, your environment will be both healthier and more beautiful!

When choosing interior materials and furniture, give preference to environmentally friendly materials and technologies!

# What can you do to help promote sustainability!



## WE HAVE A TOOL AGAINST ENERGY WASTE!



## Did you know...

- ... your various standby devices consume 60 watts!
- ... if you set your screen to optimal brightness, you can save up to 25% energy and protect your eyes!
- ... hot water boiled but not used in a week wastes 2,400 watts of energy!

## How you can help...

- Use appliances with A or A+ energy consumption!
- Do not leave your devices in Stand-by mode, unplug unused chargers!
- Do not boil more water than necessary!

# What can you do to help promote sustainability!



## RECYCLE SMART!



### Did you know...

... polluting substances that enter circulation return to us, further spreading pollution and endangering both our natural environment and human health!

... 15,000 pieces of plastic trash per square kilometre are floating in the oceans!

... the Hungarian population produces 4.2-4.4 million tons of garbage every year, which is more than 1 kg/day for an average Hungarian citizen!

### How you can help...

For example, use a canvas bag and your own mug instead of plastic bags and plastic cups!

Look for returnable or recycled packaging!

Rubbish is a pointless waste of money for you and a burden on the environment!



# What can you do to help promote sustainability!



## CLEANLINESS IS HALF WAY TO GOOD HEALTH



### Did you know...

... In Hungary, rubbish amounting to three Gellert Hills is produced every year!

... the Hungarian population produces 4.2-4.4 million tons of garbage every year, which is 1 kg/day for an average Hungarian citizen!

... unfortunately most of the landfills operate without a permit or do not comply with the regulations!

### How you can help...

Recycling is environmentally friendly, collect waste selectively!

Don't litter, keep your environment clean!

Throw any cigarette butts in the designated container!

Throw only clean waste into the selective waste bin!

Food leftovers or waste contaminated leftovers should only be thrown in a waste container with a lid!

We hope you enjoy our office building!

**CORVIN**  
INNOVATION CAMPUS

***FUTUREAL***